

34 Roslyn Avenue Kingston Beach, TAS

3 

1 

4 

SENSATIONAL SUNNY ASPECT

Capturing sensational water and mountain views from both upstairs and downstairs, this classic passive solar home is situated in the sought-after suburb of Kingston Beach.

Price:

Offers Over \$685,000



Wendy Wade

0418 561 538

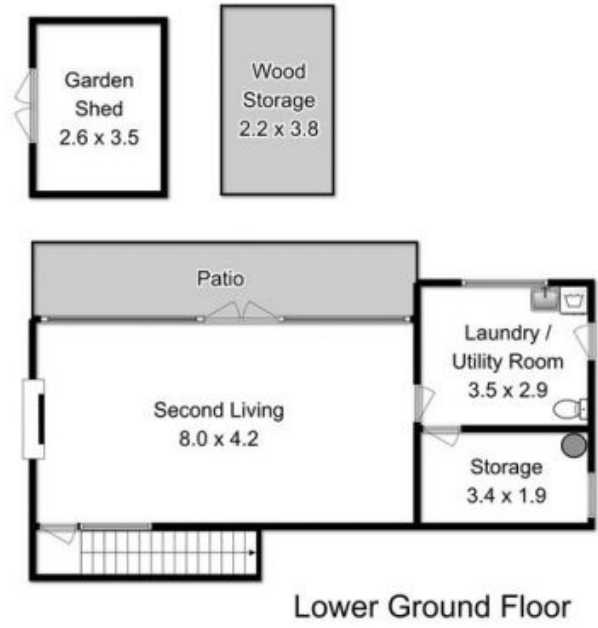

Fixtures and fittings are for display only and not to scale.
 All measurements are internal and approximate.
 This plan is a sketch for illustration, not valuation.
 Produced by Open2view.com

Approx. house area: 162 sqm
 Approx outbuilding area: 10 sqm

