

424 Lymington Road Lymington, TAS

3

1

2

6

### EXPANSIVE WATER VIEWS

This immaculately presented property looks over the Port Cygnet Bay offering panoramic views in the sought-after township of Lymington. The property is approximately 1.3 ha in size allowing enough space to enjoy all that this rural, seaside town has to offer. The house has been built with quality and functionality in mind.

Price:

Offers Over \$900,000



**Cloe Smith**

0400 581 227



**Cloe Smith**

0400 581 227

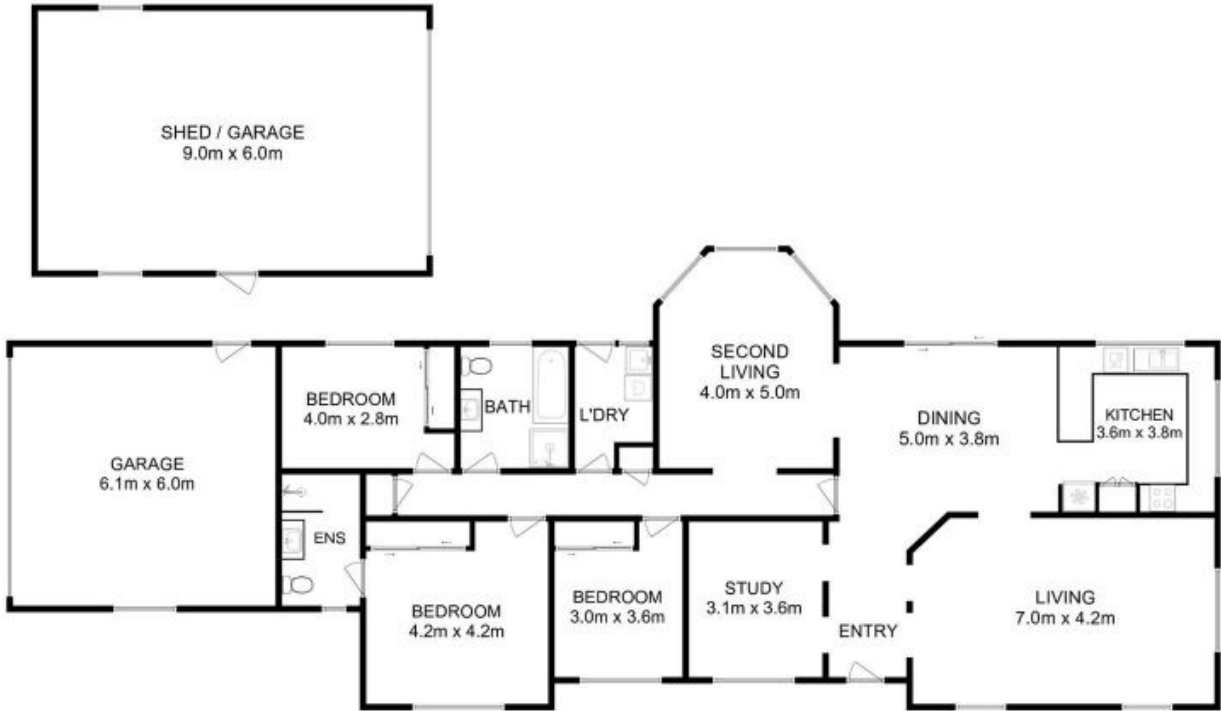

Total Approx. Floor Area : 225 sqm  
 Total Approx. Outbuilding Area : 54 sqm

All measurements are internal and approximate.  
 This plan is a sketch for illustration, not valuation.  
 Produced by Open<sup>2</sup>view.com