



84 Pottery Road Garden Island Creek, TAS

3 2 4

### Peaceful and Private

This character, story-book cottage is situated on 7 acres (approx.) of native bushland and is tucked away at the end of the driveway. It's a rural paradise waiting to be enjoyed.

**Price:** Offers Over \$625,000



**Wendy Wade**

0418 561 538



**Cloe Smith**

0400 581 227

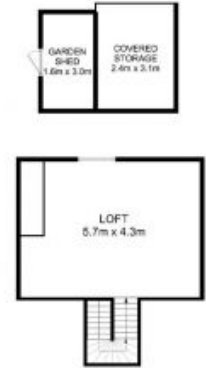
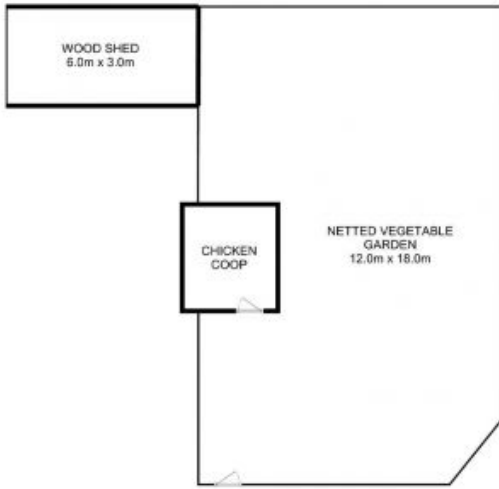

Fixtures and fittings are for display only and not to scale.  
 All measurements are internal and approximate.  
 This plan is a sketch for illustration, not valuation.  
 Produced by Open2view.com

Approx. house area: 136 sqm  
 Approx outbuilding area: 39 sqm

