



30 Tramway Crescent Margate, TAS

4

2

### MAGNIFICENT MODERN HOUSE WITH PANORAMIC VIEWS

Perched above Margate is this immaculately presented, double brick family home on approx 5 acres (2.014 ha) with magnificent 360-degree views of North West Bay, Bruny Island and the foothills of kunanyi / Mount Wellington.

Price:

Price Range \$1.25 m to \$1.35 m



**Wendy Wade**

0418 561 538



**Wendy Wade**

0418 561 538

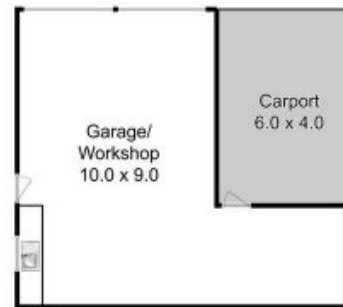
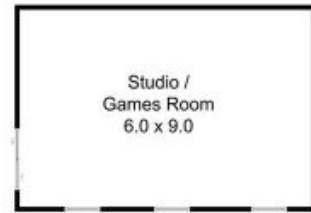

Total Approx. Floor Area : 223 sqm  
Total Approx. Outbuilding Area : 144 sqm



All measurements are internal and approximate.  
This plan is a sketch for illustration, not valuation.  
Produced by Open2view.com