



23 Peppermint Place Margate, TAS

4

2

Large Family Home on Large Block

Situated on an internal block this 4 Bedroom, 2 Bathroom family home offers you privacy and lots of space and room for the family.

Price:

Offers Over \$735,000



Louise Wallace

0429 671 462



Louise Wallace

0429 671 462

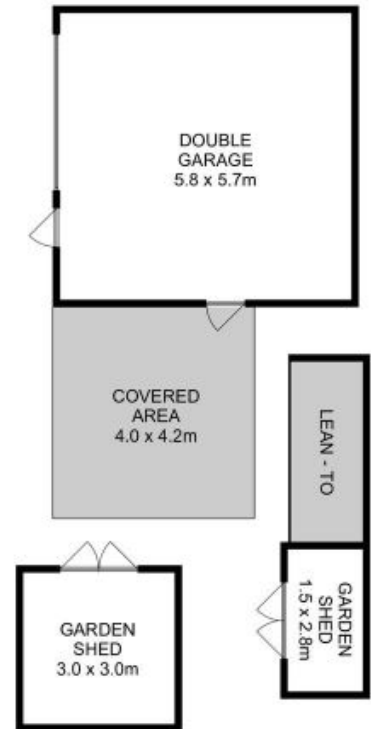

Total Approx. Floor Area : 127 sqm
Total Approx. Outbuilding Area : 47 sqm

All measurements are internal and approximate.
This plan is a sketch for illustration, not valuation.
Produced by Open2view.com