

8 Mole Avenue Southport, QLD

3

1

2

Charming family home in the heart of Chirn Park

Bathed in natural light and set on a generous 508-square-metre block, this property is perfectly located in the vibrant heart of Chirn Park. Enjoy the convenience of being within walking distance to Southport State High, Chirn Park restaurant and cafe precinct, and the stunning Broadwater.

Price: \$820 pw
Available Date: 26/11/2024



Stefanie Mullin

0413 707 396

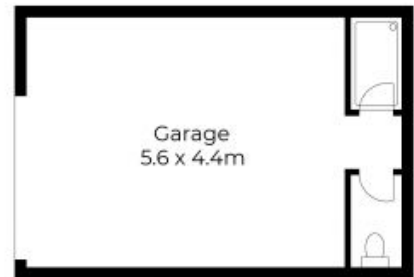

Floor plans and site plans are for illustrative purposes only. They are not part of any legal document or title and are subject to errors, omission, and inaccuracies. Whilst every attempt has been made to ensure the accuracy of this plan, measurements of doors, windows, rooms, cupboards etc are approximate only.

APPROXIMATE AREA
LIVING AREA : 124 m²
TOTAL AREA : 155 m²