

4/168 The Entrance Road The Entrance, NSW



## Exquisite Townhouse Living

Experience the epitome of exquisite townhouse living - an unparalleled opportunity for those in pursuit of a low-maintenance lifestyle and a stunning, contemporary home in the coveted beachside haven. Discover the allure of these brand-new, luxury townhouses that cater to every aspiration, whether you're a bustling professional, a growing family, a savvy downsizer, or a blissful holiday maker.

Nestled in a highly sought-after beachside locale, this remarkable offering presents an idyllic retreat where you can revel in the beauty of coastal living without compromising on modern comforts. Each thoughtfully designed townhouse is a testament to elegance, crafted with meticulous attention to detail, providing a truly opulent living experience.

Seamlessly blending style and practicality, these townhouses grant you the freedom to savour life's pleasures, unburdened by maintenance concerns. Embrace the convenience of a vibrant, laid-back lifestyle, tailor-made for your needs and desires.

Situated in the heart of the Central Coast, betwixt The Entrance Beach and Tuggerah Lake you'll relish the e...

With your new townhouse's prime location, these exciting family activities are always within easy reach. Bond with your loved ones as you create cherished moments filled with joy, laughter, and the sheer delight of coastal living. Your family's perfect adventure awaits ...

**Price:** \$850,000



**Shanti Santhou**

0437787221

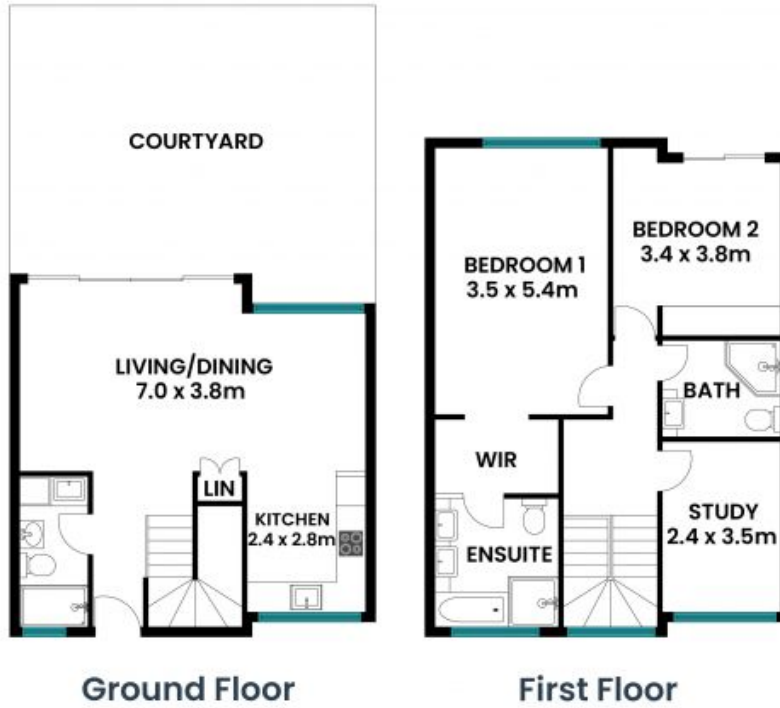

Internal Area: 113sqm  
External Area: 00sqm

PLEASE NOTE: These Floor Plan + Site Plans have been generated for marketing purposes and are to be used as a guide only. While all care is taken, no guarantee can be given in respect of accuracy, sizes and dimensions are approximate, actual may vary.

