



13/10-16 Station Street Thornleigh, NSW

2 

2 

1 

Sold by Mathew Ferraro 0416 449 073

Sold by Mathew Ferraro 0416 449 073

Whether you are an owner occupier or investor this two-bedroom unit caters to all. Situated in the heart of Thornleigh, its prime location offers unparalleled convenience, with Thornleigh Station and local shops just a short walk away! 'The Mahli' is a highly sought-after contemporary complex designed to offer a range of luxurious features including, two-zone ducted air conditioning systems and a generously sized balcony, ideal for year-round enjoyment. The kitchen is equipped with high-quality gas appliances and a sleek mirrored splashback, adding both style and functionality to the home.

Price:

Sold by Mathew Ferraro 0416 449 073



Mathew Ferraro

0416 449 073

13/10-16 Station Street
Hornsby

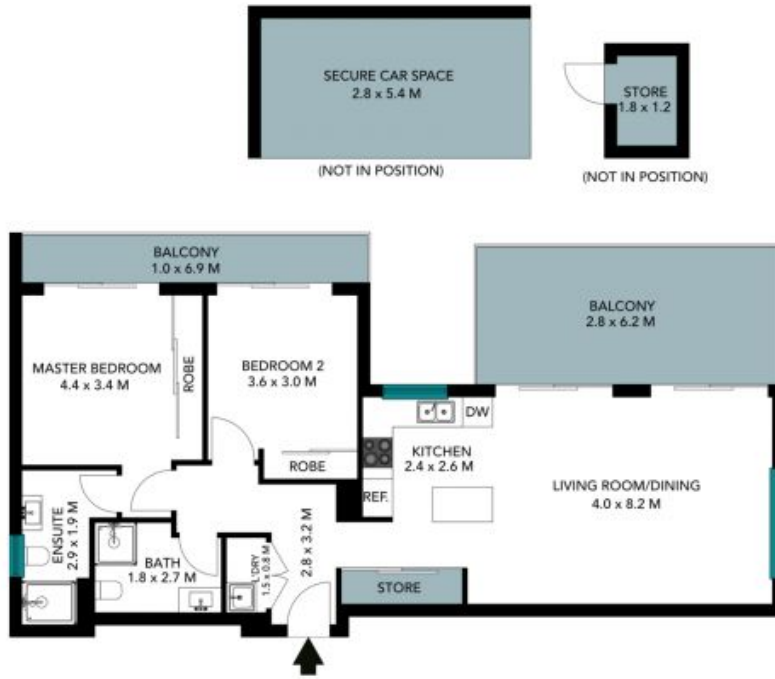

The floor plan is not to scale, measurements are indicative and in metres. Exterior elements are not in position. Plans should not be relied on, interested parties should make and rely on their own enquiries. All other information provided has been collected from reliable sources but cannot be guaranteed for accuracy.

13/10-16 Station Street
Hornsby



The floor plan is not to scale; measurements are indicative and in metres. All features included in this 3D plan are for inspiration purposes only. This is not an exact replica of the property or the position of exterior elements. Plans should not be relied on. Interested parties should make and rely on their own enquiries.