



403A Mona Vale Road St Ives, NSW



Spacious Light filled residence creates exciting appeal for an ideal family lifestyle.

Basking in a premier northerly aspect, this residence by 'Provincial Homes' is perfectly suited for effortless family living and entertaining. Its bright living and dining rooms enjoy a spacious open plan design, complemented by flowing access towards the sun drenched entertaining deck and child-friendly backyard. It occupies a 295.8sqm level block of land that's positioned within close proximity to reserves, transport, Sydney Grammar Preparatory School and Brigidine College St Ives.

Price:

Contact Agent



Andy Howden

0423 264 989



GROUND FLOOR



UPPER FLOOR

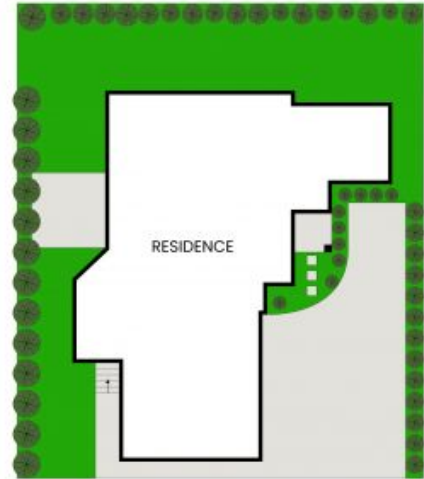

SITE PLAN

Internal Area : 182 SQM
Land Size: 296 SQM



The site plan and floor plan are not to scale; measurements are indicative and in metres. Bushes and trees are placed for illustration purposes. Plans should not be relied on. Interested parties should make and rely on their own enquiries. All other information provided has been collected from reliable sources but cannot be guaranteed for accuracy.