



43 Ellery Parade Seaforth, NSW



Executive entertainer with all the bells and whistles

Enjoying a completely private, north-facing garden setting in one of Seaforth's best streets, this lovely home offers a tranquil oasis where indoors and out blend seamlessly for year 'round living and entertaining. With easy-care gardens, free-flowing interiors and a spacious floorplan, this charming haven offers a wonderful opportunity to secure the ideal coastal home.

Price: Leased
Available Date: 03/02/2025



Anthony Zakos

0419 503 000



Alicia Sudol

0459 996 944

43 Ellery Parade
Seaforth



Internal Living: 250 sqm
 External Living: 40 sqm
 Total Living Area: 290 sqm



STONE

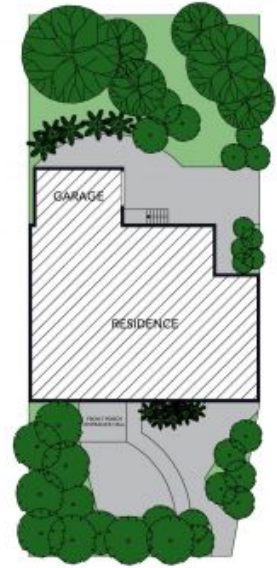

The site plan and floor plan are not to scale; measurements are indicative and in metres. Bushes and trees are placed for illustration purposes. Plans should not be relied on. Interested parties should make and rely on their own enquiries. All other information provided has been collected from reliable sources but cannot be guaranteed for accuracy.

43 Ellery Parade
Seaforth



Ground Floor

Internal Living: 250 sqm
External Living: 40 sqm
Total Living Area: 290 sqm



First Floor



The floor plan is not to scale; measurements are indicative and in metres. All features included in this 3D plan are for inspiration purposes only. This is not an exact replica of the property or the position of exterior elements. Plans should not be relied on. Interested parties should make and rely on their own enquiries.