



42 Corella Drive Whittlesea, VIC

5 

1 

2 

2 

### Your Dream Home Awaits in Crystal Views!

Discover the perfect family retreat in this beautifully maintained 5-bedroom home, complete with a study for added versatility. Thoughtfully designed, this property offers two spacious living areas, making it ideal for both everyday living and entertaining. From its stylish new floors to its incredible outdoor features, this home delivers comfort, convenience, and lifestyle.

Price: \$790,000



Dean Zammit

0405 140 704

42 Corella Drive  
Whittlesea

STONE



The floor plan is not to scale; measurements are indicative and in metres. All features included in this 3D plan are for inspiration purposes only. This is not an exact replica of the property or the position of exterior elements. Plans should not be relied on. Interested parties should make and rely on their own enquiries.

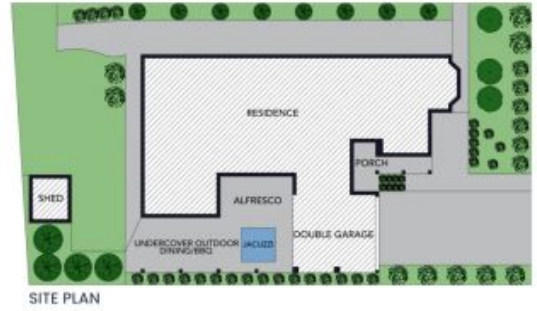

The site plan and floor plan are not to scale; measurements are indicative and in metres. Bushes and trees are placed for illustration purposes. Plans should not be relied on. Interested parties should make and rely on their own enquiries. All other information provided has been collected from reliable sources but cannot be guaranteed for accuracy.