



25 Albert Street Petersham, NSW

5 2 1

Splendid family home with inspiring potential

Occupying a stunning 582sqm block on a quiet street, the spacious interiors of this freestanding dual level home combine beautifully maintained period details with chic updates, offering a wonderful haven for busy family life and relaxed entertaining. Its ideal location sees top schools, cafes, shops, parks and transport within a 750m radius, with the bustle of Enmore Road just over 1km away.

Price: \$3,470,000
Council Rates: \$583.62 p/q
Water Rates: \$194.00 p/q



Joseph Tropiano

0401 002 211



Irma Rinaudo

0426 240 502

25 Albert Street
Petersham



Lower Ground Floor



Ground Floor



The floor plan is not to scale; measurements are indicative and in metres. All features included in this 3D plan are for inspiration purposes only. This is not an exact replica of the property or the position of exterior elements. Plans should not be relied on. Interested parties should make and rely on their own enquiries.

25 Albert Street
Petersham

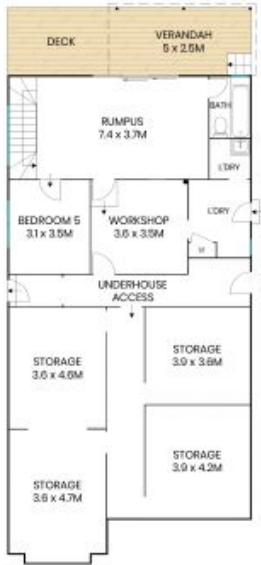

Lower Ground Floor



Ground Floor



Site Plan

Internal Living: 301sqm
External Living: 441sqm
Total Living Area: 583sqm



The site plan and floor plan are not to scale; measurements are indicative and in metres. Bushes and trees are placed for illustration purposes. Plans should not be relied on. Interested parties should make and rely on their own enquiries. All other information provided has been collected from reliable sources but cannot be guaranteed for accuracy.