



494 Manuka Road Kettering, TAS



PREMIUM HOME WITH WATER VIEWS, SUSTAINABILITY IN MIND, AND IMPRESSIVE WORKSHOP

Discover a premium lifestyle in this beautifully updated residence, perfectly positioned along sought-after Manuka Road. Offering breathtaking views over the Kettering marina and an expansive 2.25-hectare (approx. 5.5-acre) property, this home is designed for astute buyers seeking quality, space, and versatility.

Price: Offers Above \$1,150,000
Council Rates: \$1,229.00/year (approx)



Cloe Smith

0400 581 227



Cloe Smith

0400 581 227

▼ Ground Floor

TOTAL AREA: 524.57 m² - LIVING AREA: 188.65 m²

494 Manuka Road,
Kettering TAS

CREATED ON
2025-01-29

LOCATION
494 Manuka Road
7155 Kettering
Tasmania
AU

DETAILS
Total area: 524.57 m²
Living area: 188.65 m²

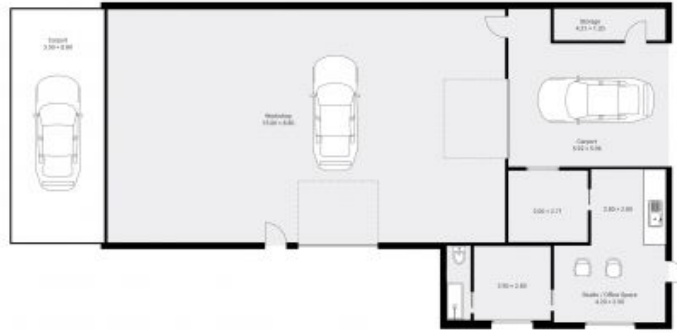

THIS FLOORPLAN IS PROVIDED WITHOUT WARRANTY OF ANY KIND. GROUNDUP IMAGING DISCLAIMS ANY WARRANTY INCLUDING WITHOUT LIMITATION, ANY DIRECT OR INDIRECT LIABILITY OF ACCURACY OF DIMENSIONS.