



50 O'Donnell Crescent Lisarow, NSW

4 

2 

2 

Sold by Brian Milson & Joey Lewis!

Price: \$1,225,000



Brian Milson

0411 381 220



Joey Lewis

0411 803 708

50 O'Donnell Crescent
Lisarow



Ground Floor



First Floor

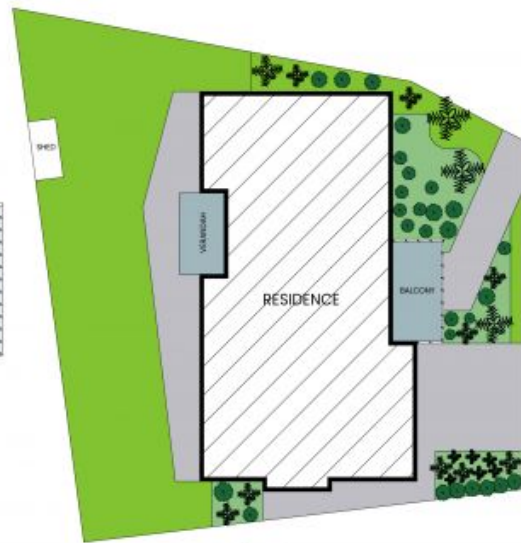

Site Plan

Internal Area: 225 sqm
 External Area: 32 sqm
 Garage Area: 44 sqm
 Total Area: 301 sqm

PLEASE NOTE: These Floor and Site Plans have been generated for marketing purposes and are to be used as a guide only. While all care is taken, no guarantee can be given in respect of accuracy, sizes and dimensions are approximate, actual may vary.

