



53 Clements Street Russell Lea, NSW



Statement home of luxurious scale in prized setting

Defined by a luxurious sense of space and style, this exquisitely finished full brick residence promises a superb standard of contemporary family living and entertaining. Sunlit interiors extend over three expansive levels, with a selection of private settings to soak up the surrounds. Dazzling water views attest the home's sought-after address, just a stroll from parklands along the Bay Run.

Price: \$5,500,000

Council Rates: \$476.00 p/q

Water Rates: \$173.29 p/q



Joseph Tropiano

0401 002 211



Irma Rinaudo

0426 240 502

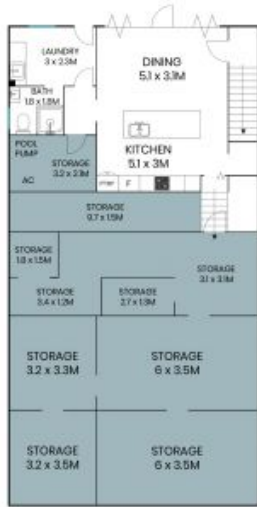

Lower Ground Level

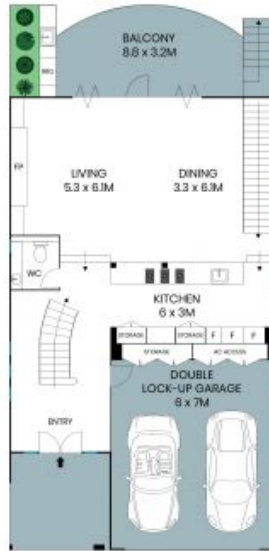

Ground Level



Level One



Site Plan



The site plan and floor plan are not to scale; measurements are indicative and in metres. Bushes and trees are placed for illustration purposes. Plans should not be relied on. Interested parties should make and rely on their own enquiries. All other information provided has been collected from reliable sources but cannot be guaranteed for accuracy.

53 Clements Street
Russell Lea



Lower Ground Level



Ground Level



Level One



The floor plan is not to scale; measurements are indicative and in metres. All features included in this 3D plan are for inspiration purposes only. This is not an exact replica of the property or the position of exterior elements. Plans should not be relied on. Interested parties should make and rely on their own enquiries.