



3/16 Murray Road Beecroft, NSW

3 2 2

Exclusive 'Maldon' over 55's residence of executive luxury

A masterpiece in premium design precision-built by renowned Caxton Group and Craig Young Homes, this exceptional three-bedroom residence delivers a rare over 55's lifestyle package in a lush community of just 11 boutique residences. Luxuriating in high-end appointments, beautifully landscaped grounds and impressive open space, it's one of a select few superior crafted retreats in Sydney's north and enjoys all Beecroft village conveniences nearby.

Price: Sold by Kevin Dearlove
Council Rates: \$417.00 p/q
Water Rates: \$172.79 p/q
Strata Rates: \$1,452.00 p/q



Kevin Dearlove

0403 338 302

3/16 Murray Road, Beecroft

3 2 2 2 201m² 238m²

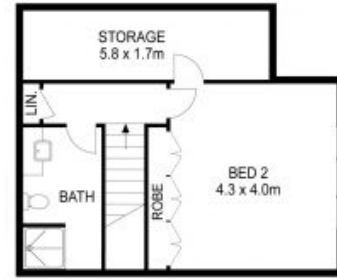

UPPER LEVEL

THIS IS AN ARTIST'S IMPRESSION - ALL DIMENSIONS, LAYOUTS AND TREES ARE APPROXIMATE
ALL INTERESTED PARTIES SHOULD MAKE AND RELY ON THEIR OWN ENQUIRIES

