

8/2-12 Busaco Road Marsfield, NSW



Sold by Mathew Ferraro 0416 449 073

Price:

Sold by Mathew Ferraro 0416 449 073

Sold by Mathew Ferraro 0416 449 073

This immaculate townhouse, with a classic full brick exterior, fresh interiors, and a private courtyard, offers an ideal opportunity for downsizers, investors, and young families. Located on the border of Macquarie Park and Epping, it features spacious living areas with a north-westerly aspect, flooding the home with natural light. Just 45 meters to the bus stop, 1.1km to Macquarie University Hospital, and 1.6km to Macquarie University Metro Station, it's also close to schools, Macquarie Centre, parks, and major access roads like the M2.



Mathew Ferraro

0416 449 073

8/2-12 Busaco Road
Marsfield

STONE

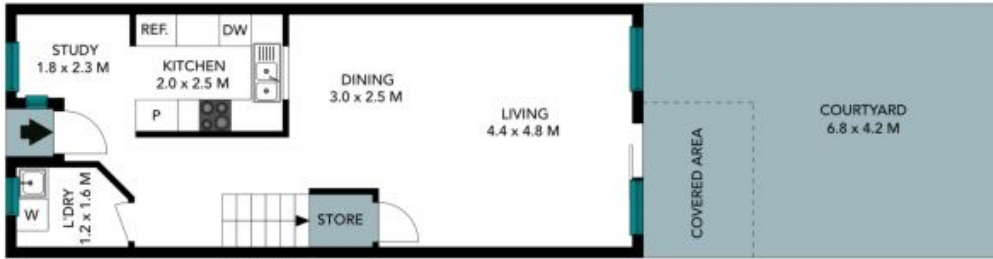

Ground Floor



First Floor

The floor plan is not to scale, measurements are indicative and in metres. Exterior elements are not in position. Plans should not be relied on, interested parties should make and rely on their own enquiries. All other information provided has been collected from reliable sources but cannot be guaranteed for accuracy.

8/2-12 Busaco Road
Marsfield



Ground Floor



First Floor



The floor plan is not to scale; measurements are indicative and in metres. All features included in this 3D plan are for inspiration purposes only. This is not an exact replica of the property or the position of exterior elements. Plans should not be relied on. Interested parties should make and rely on their own enquiries.