



15 Turner Street Lambton, NSW



Low Maintenance Living with Lifestyle Location

Situated in one of Lambton's most sought-after streets, this meticulously maintained five-bedroom residence offers low maintenance living just moments to beautiful Lambton Park, Lambton Pool and Village shops located at Elder Street. Featuring a spacious open plan design with a versatile layout that could be used as five beds or four beds and multiple living areas.

Price:

Sold



Todd Mason

0427 480 780



Sienna Mason

0407 809 981

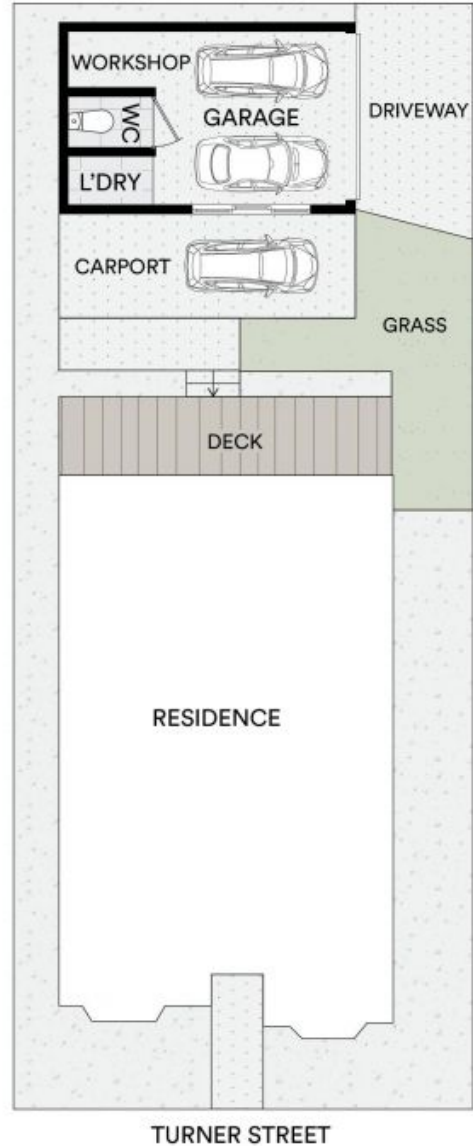

All information contained in this document is from sources we believe to be accurate, however we cannot guarantee its accuracy. Interested persons should make and rely on their own enquiries in relation to measurements, dimensions, layout, furniture and descriptions.

INTERNAL AREA: 147M²
EXTERNAL AREA: 22M²