



53 Stowport Avenue Crace, ACT

3 2 2

**Sold at Auction - \$961,000**

**Price:** SOLD - \$961,000

Crace is more than just a place to live- it's a community designed for connection, convenience, and a balanced lifestyle. This beautifully designed home embodies the best of modern living, offering space, comfort, and effortless style.



**Jess Smith**

0410 125 475



**Alex Ogbonna**

0423 535 024

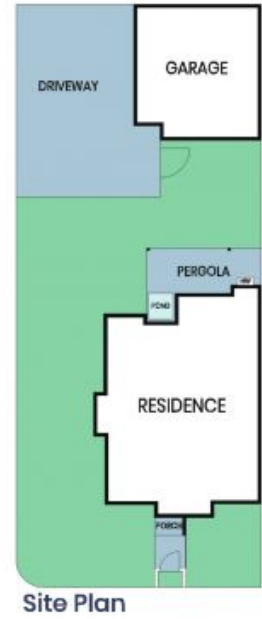
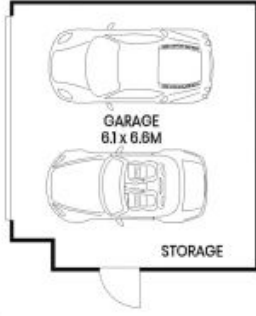
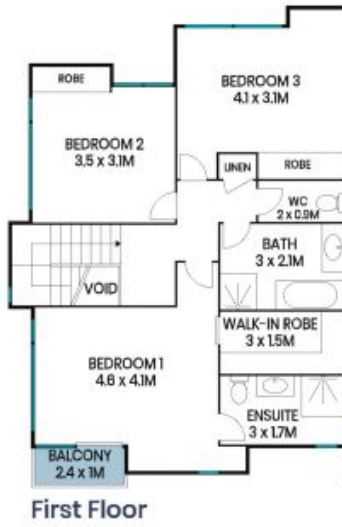

The site plan and floor plan are not to scale; measurements are indicative and in metres. Bushes and trees are placed for illustration purposes. Plans should not be relied on. Interested parties should make and rely on their own enquiries. All other information provided has been collected from reliable sources but cannot be guaranteed for accuracy.

53 Stowport Avenue  
Crace



First Floor



Ground Floor



The floor plan is not to scale; measurements are indicative and in metres. All features included in this 3D plan are for inspiration purposes only. This is not an exact replica of the property or the position of exterior elements. Plans should not be relied on. Interested parties should make and rely on their own enquiries.