



12 Links Crescent Joyner, QLD

5 2 2

Great Location! 701m² Block! Pool!

Team Doyle from Stone Real Estate are thrilled to present 12 Links Crescent to the market. A spacious family home set on a 701m² block, perfectly positioned in the sought-after Links Estate, Joyner. Offering a seamless blend of indoor and outdoor living, this well-maintained residence delivers comfort, convenience, and move-in-ready appeal.

Price: Offers Over \$1,050,000
Council Rates: \$500.00 p/q
Water Rates: \$320.00 p/q



Team Doyle

0414 666 536

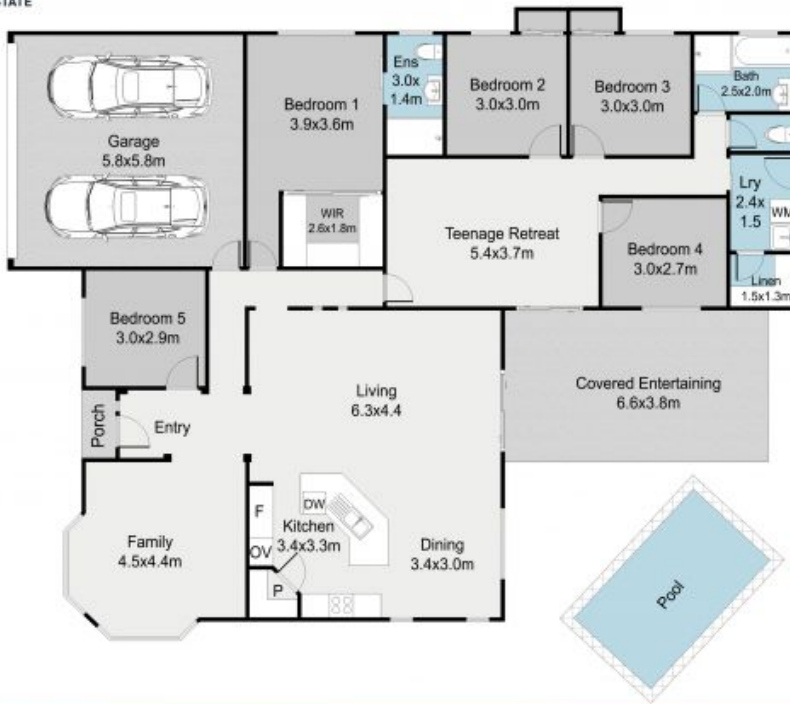

12 Links Crescent, Joyner

APPROX SQM
Internal: 231 SQM
External: 26 SQM

The floor plan is not to scale; measurements are indicative and in metres. Exterior elements are not in position. Plans should not be relied on. Interested parties should make and rely on their own enquiries.