



60A Cardinal Avenue Beecroft, NSW



Street Frontage Brick Home on high side in CGHS catchment

The storybook frontage and tree-canopied backdrop of this inviting red brick residence is perfectly in keeping with its picturesque Beecroft setting. A home of warmth and character enjoyed by the same family for almost three decades, it provides lower level flexible living or guest accommodation with private access, alongside sun-dappled interiors, terraced gardens and outdoor entertaining areas. All concluded by a blue-chip address - zoned for Cheltenham Girls and Carlingford High School.

Price: Sold by Kevin Dearlove
Council Rates: \$574.20 p/q
Water Rates: \$169.03 p/q



Kevin Dearlove

0403 338 302

60A Cardinal Avenue, Beecroft



3 2 2 2 696.8m²

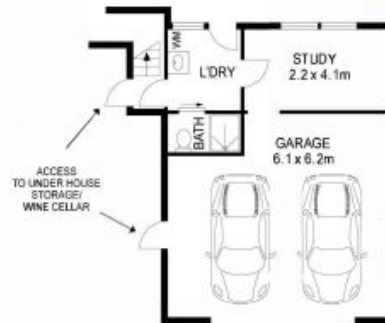

THIS IS AN ARTIST'S IMPRESSION - ALL DIMENSIONS, LAYOUTS AND TREES ARE APPROXIMATE
ALL INTERESTED PARTIES SHOULD MAKE AND RELY ON THEIR OWN ENQUIRIES

