



10/1625 Pacific Highway Wahroonga, NSW



Sold August 2025 - Contact James Ramsay 0420 665 913.

Promising enviable lifestyle convenience at the epicentre of Wahroonga village precinct, this established ground floor apartment within the boutique 'The Kyles' development offers a compelling combination of spacious sun filled interiors and the freedom of lock-and-leave ease. It enjoys an impressive 117.67sqm on title advantaged by north to rear orientation, in a picture perfect manicured garden setting steps from local cafe culture - and directly opposite city buses and Abbotsleigh.

Price: For Sale
Council Rates: \$383.00 p/q
Water Rates: \$170.90 p/q
Strata Rates: \$1,171.05 p/q



James Ramsay

0420 665 913



Chloe Mawass

0431 983 240

10/1625 Pacific Highway, Wahroonga



2 1 1

STORAGE
CAGE
(NOT IN POSITION)

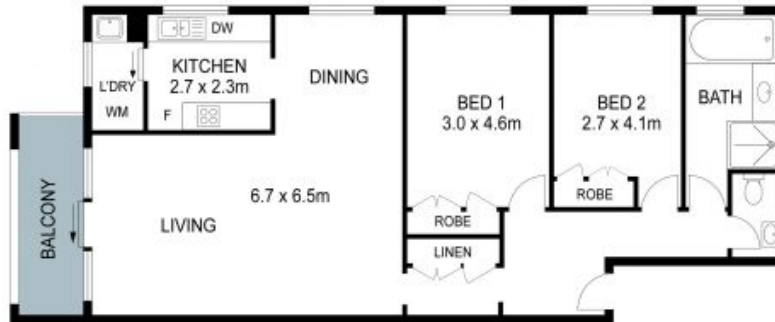
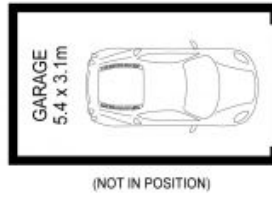

THIS IS AN ARTIST'S IMPRESSION - ALL DIMENSIONS, LAYOUTS AND TREES ARE APPROXIMATE
ALL INTERESTED PARTIES SHOULD MAKE AND RELY ON THEIR OWN ENQUIRIES

