

6/55-59 Scenic Highway Terrigal, NSW



Elegant Coastal Living ? A Rare Offering in Terrigal

Perfectly positioned just moments from the heart of Terrigal, this beautifully appointed 3 bedroom townhouse at 6/55 Scenic Highway presents an exclusive opportunity to secure a sophisticated residence in one of the Central Coast's most desirable beach side enclaves.

Price: Contact Agent
Council Rates: \$293.97 p/q
Water Rates: \$265.75 p/q



David Lyle

0408 440 010



David Lyle

0408 440 010

6/55 Scenic Highway,
Terrigal

STONE



Lower Level

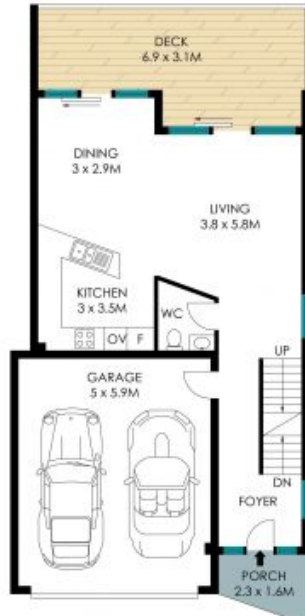

Ground Level



Upper Level

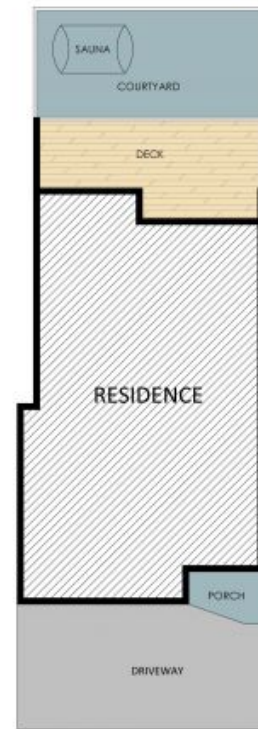

Site Plan



Total Living Area: 221 sqm

The site plan and floor plan are not to scale; measurements are indicative and in metres. Bushes and trees are placed for illustration purposes. Plans should not be relied on. Interested parties should make and rely on their own enquiries. All other information provided has been collected from reliable sources but cannot be guaranteed for accuracy.