



6/1 Lusty Place Moorebank, NSW



Original townhouse with scope in quiet cul-de-sac

Inviting and cosy, this original townhouse presents an exceptional opportunity for first homebuyers to renovate or personalise to suit taste (STCA). Its ideally set in a quiet cul-de-sac, within walking distance of Moorebank shops and public transport.

- Dual level layout includes spacious lounge and dining area
- Alfresco entertaining on easycare sun drenched courtyard
- Kitchen fitted with electric cooktop and tiled splashback
- Two bedrooms with built-in wardrobes, master includes study
- Potential to extend into the study and create huge master
- Full main bathroom, internal laundry with additional w/c
- Air conditioning, single lock-up garage with internal access
- Short drive to Moorebank Shopping Centre, Liverpool Station

Stone Real Estate

02 9824 1100
Liverpool

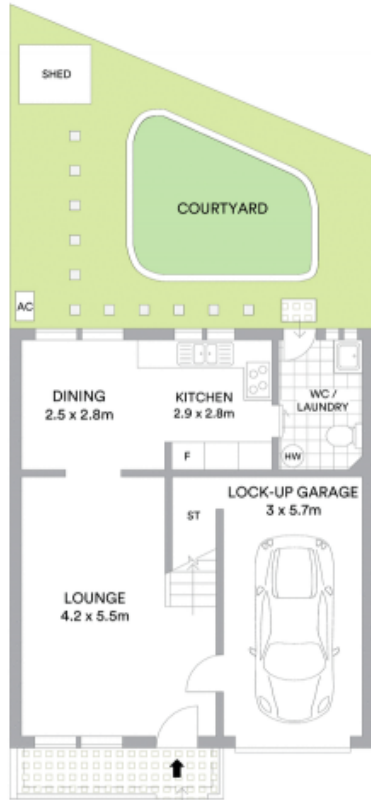

GROUND FLOOR

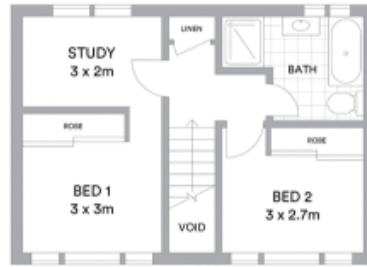

FIRST FLOOR



McGrath

Scale in metres. Indicative only. All information contained herein is obtained from sources we believe to be accurate. We cannot guarantee its accuracy. Interested persons should make and rely on their own enquiries.