



12 Batehaven Close Prestons, NSW



Spacious family residence nestled in quiet pocket

Positioned with an ideal north east to rear aspect, this two storey residence is a relaxed family haven of light and space. It occupies a 521sqm block of land in a private cul-de-sac, minutes away from Dalmeny Public School and Carnes Hill Marketplace.

Stone Real Estate

02 9824 1100
Liverpool

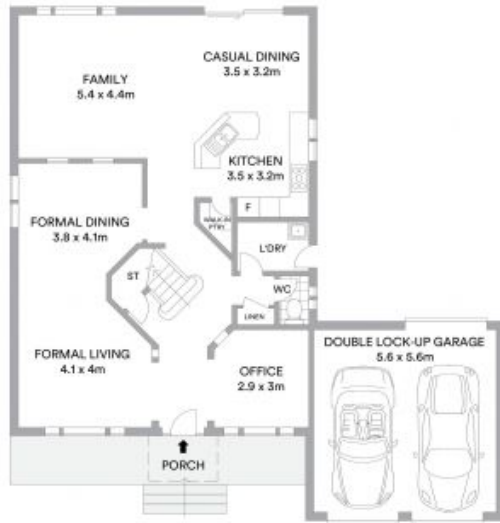

GROUND FLOOR



FIRST FLOOR



Batehaven Close



McGrath

Scale in metres. Indicative only. All information contained herein is obtained from sources we believe to be accurate. We cannot guarantee its accuracy. Interested persons should make and rely on their own enquiries.