

11 Maxwell Place Abbotsbury, NSW



Sold by McGrath Estate Agents Liverpool

Commanding breathtaking street appeal, this quality built Rawson residence presents a unique opportunity in the sought after Abbotsbury Meadows. Equipped with the finest of finishes throughout and conveniently placed close to shops, lake and parklands.



Frank Bartolone

0411 477 758



Angela McInerney

0435 348 141

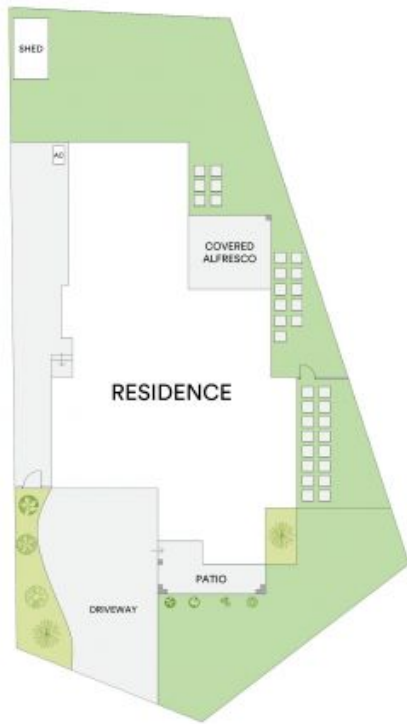

GROUND FLOOR



FIRST FLOOR

Internal 278sqm
 External 403sqm
 Land area 600sqm

McGrath

Scale in metres. Indicative only. All information contained herein is obtained from sources we believe to be accurate. We cannot guarantee its accuracy. Interested persons should make and rely on their own enquiries.