



75-77 Leacocks Lane Casula, NSW

6 2 4

### Sold by Glen Craigie & Frank Bartolone

Opposite the scenic Leacock Regional Park, this expansive residence presents development or dual living potential (STCA) on a 1,774sqm parcel with dual street frontages. Its walking distance to All Saints Catholic College, buses to Liverpool CBD plus convenient to Casula Mall, Glenfield and Casula stations.



**Frank Bartolone**

0411 477 758



**Glen Craigie**

0401 529 930





FIRST FLOOR

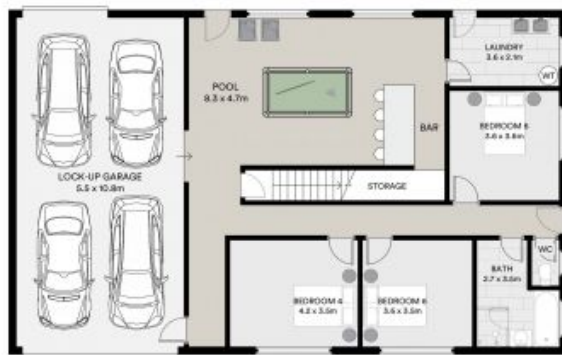

GROUND FLOOR



INTERNAL AREA : 360 M<sup>2</sup>  
 LAND AREA : 1,774 M<sup>2</sup>

All information contained in this document is from sources we believe to be accurate, however we cannot guarantee its accuracy. Interested persons should make and rely on their own enquiries in relation to measurements, dimensions, layout, furniture and descriptions.