



9 Culverston Avenue Denham Court, NSW

6 3 6

Sold by Glen Craigie

Tightly held for 29 years, this architecturally crafted single level residence creates a stunning retreat for growing families on 2.5 beautiful acres of land. Nestled with a serene bushland backdrop, it's handy to Edmondson Park Station and Ed.Square Shopping Centre.



Glen Craigie

0401 529 930



Glen Craigie

0401 529 930

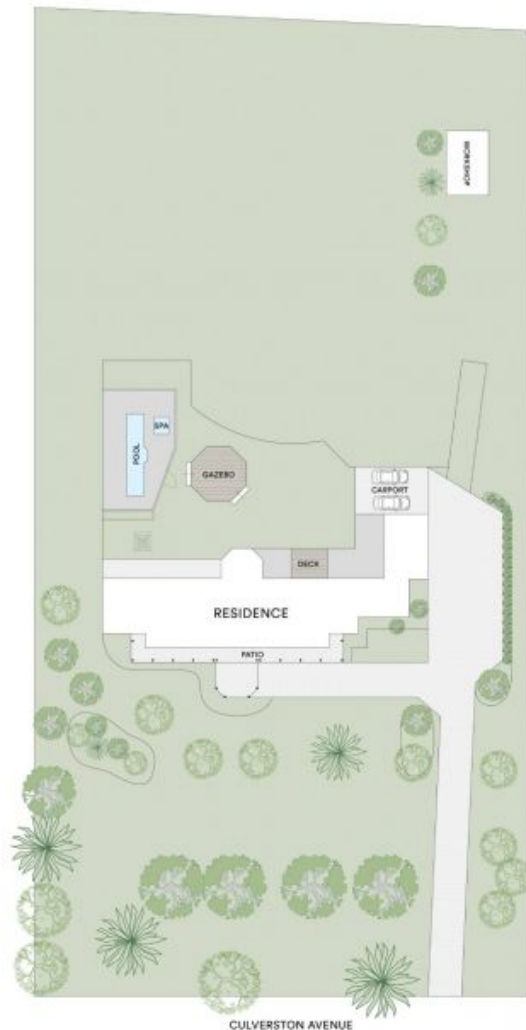

CULVERSTON AVENUE



All information contained in this document is from sources we believe to be accurate, however we cannot guarantee its accuracy. Interested persons should make and rely on their own enquiries in relation to measurements, dimensions, layout, furniture and descriptions.