



14/19 Troopers Mews Holsworthy, NSW



Sold by McGrath Estate Agents Liverpool

Perfectly positioned for utmost convenience, this immaculate freestanding townhome offers a light filled easycare layout. It's peacefully placed in a private estate bordering Harris Creek Reserve, within an easy walk of Holsworthy Station and local schools.

- Set at the end of quiet cul-de-sac, ideal for young families
- Well presented interior has separate lounge and dining rooms
- Interior flows outdoors to the wraparound child-friendly yard
- The bright modern style kitchen is equipped with gas cooking
- Bedrooms are appointed with built-ins, master has a walk-in
- Well appointed three way bathroom plus a guest powder room
- Understair storage and fresh paint/carpet
- Great first home or a solid investment with strong returns

Price:

Price guide \$590,000 - \$640,000

Stone Real Estate

02 9824 1100
Liverpool

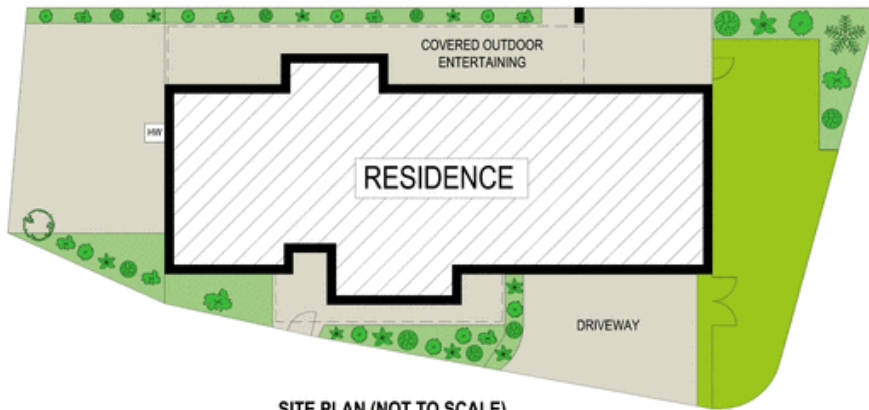

SITE PLAN (NOT TO SCALE)

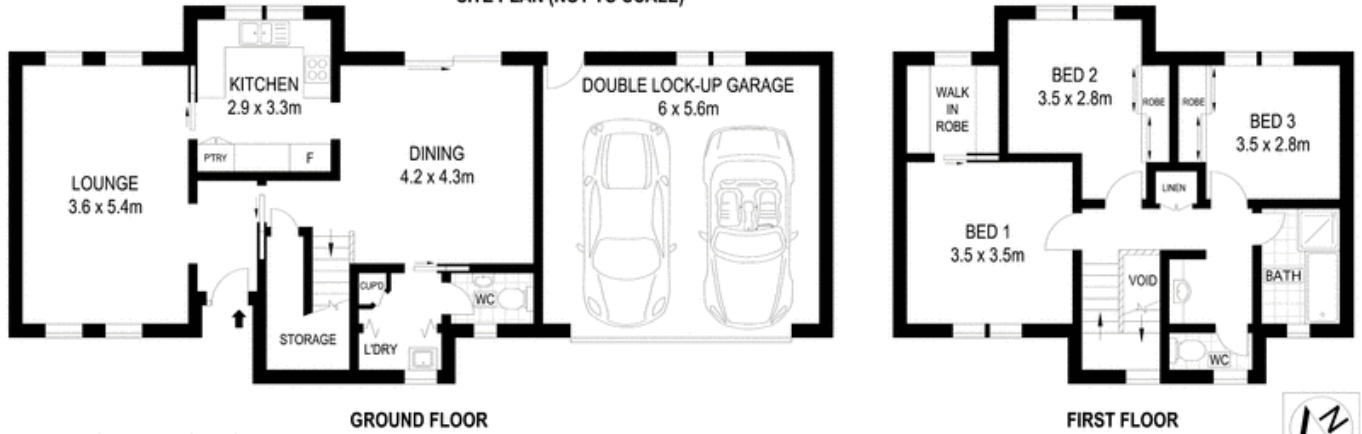

Scale in metres. Indicative only. Dimensions are approximate. All information contained herein is gathered from sources we believe to be reliable. However we cannot guarantee its accuracy and interested persons should rely on their own enquiries.

14/19 Troopers Mews, Holsworthy

McGrath