



45 Peugeot Drive Ingleburn, NSW

5 

3 

2 

Sold by Glen Craigie, McGrath Estate Agents

Directly adjoining nature reserve in the prestigious 'Carrs Estate', this beautifully appointed, spacious home has been completely renovated and extended with contemporary family living and entertaining in mind. It's moments to schools, shops and transport.

- Formal lounge room with gas fireplace, media/living room
- Open plan kitchen and dining flows to alfresco entertaining
- Large, level yard is fully fenced with gate to rear reserve
- Ultra-modern gas kitchen with stone benchtops, breakfast bar
- Four upstairs bedrooms with built-ins, plus one downstairs
- Generous master retreat with walk-in wardrobe and ensuite
- Stunning bathrooms with dual sinks and rain shower heads
- Ducted air conditioning, security and plantation shutters



Glen Craigie

0401 529 930



Glen Craigie

0401 529 930

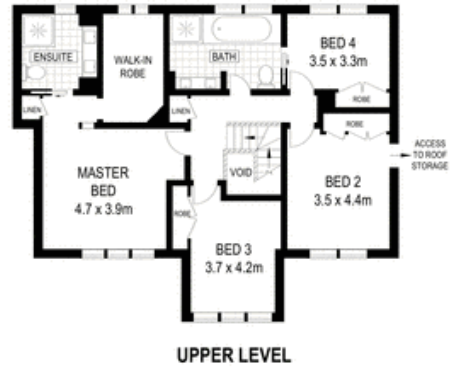

Scale in metres. Indicative only. Dimensions are approximate. All information contained herein is gathered from sources we believe to be reliable. However we cannot guarantee its accuracy and interested persons should rely on their own enquiries

45 Peugeot Drive, Ingleburn



McGrath