



8 Mount Street Bonnyrigg Heights, NSW



Newly updated home provides untold family comfort

Centrally located, generously proportioned and newly modernised, this expansive home offers comfort, style and convenience for a growing family. It's set on a corner 603sqm block on the high side of the street, within a walk of schools, parks and buses.

- Dual level layout, separate lounge, dining and family areas
- Rear north aspect maximises natural light in living spaces
- Updates include new tiles, carpet, paint and bathrooms
- Easy flow to covered alfresco entertaining area, level lawn
- Scope for addition of detached streetfacing granny flat (STCA)
- Four upstairs bedrooms, all equipped with built-in wardrobes
- Sleek master ensuite, family bathroom with freestanding tub
- Gas cooking, ducted air conditioning, picture windows, alarm

Price:

Price guide \$850,000 - \$900,000

Stone Real Estate

02 9824 1100
Liverpool

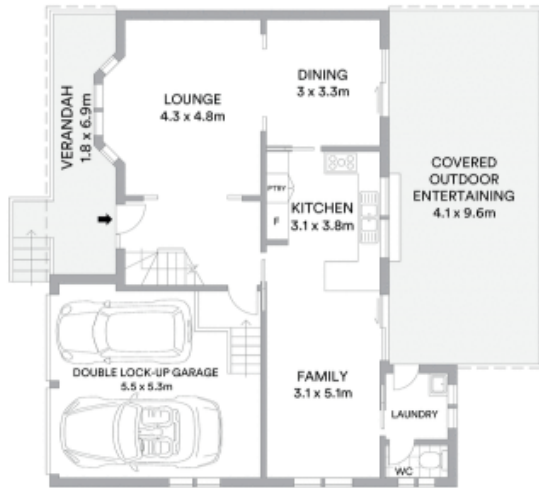

GROUND FLOOR



FIRST FLOOR



Land area 603sqm

McGrath

Scale in metres. Indicative only. All information contained herein is obtained from sources we believe to be accurate. We cannot guarantee its accuracy. Interested persons should make and rely on their own enquiries