



230 Epsom Road Chipping Norton, NSW

3

1

1

Sold By McGrath Estate Agents Liverpool

Price: \$810,000 - \$860,000

Situated in a highly sought-after suburb on an impressive 718sqm, this property has been zoned for R3 and presents a unique opportunity to develop in an already established area. It is a walk to Liverpool bound buses, while handy to local shops and cafes.

- Approved R3 Zoning brings immense development potential
- Expansive 718sqm parcel has a substantial 17.8 metre frontage
- Create dream family home to custom specifications (STCA)
- Ready to enjoy, plus scope to add personal touches (STCA)
- Lucrative duplex potential, live in one rent the other (STCA)
- Level land, minimal established trees, ideal for builders
- Existing home is ready to enjoy while plans are drawn up
- Separate living and dining zones, original electric kitchen

Stone Real Estate
02 9824 1100
Liverpool

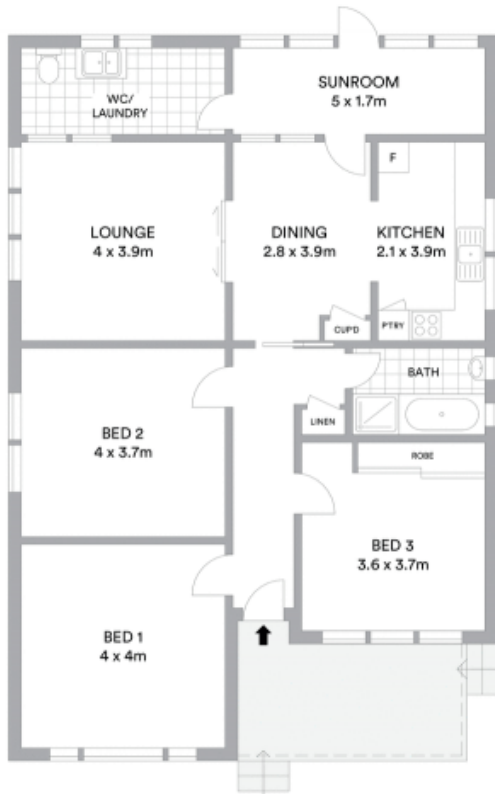

Land area 718.7sqm

McGrath

Scale in metres. Indicative only. All information contained herein is obtained from sources we believe to be accurate. We cannot guarantee its accuracy. Interested persons should make and rely on their own enquiries