

74/39 Lachlan Street Warwick Farm, NSW



**Sold by Glen Craigie, McGrath Estate Agents**

Nestled in a popular modern complex, this contemporary apartment has been immaculately maintained and offers an abundance of space, style and comfort. Perfectly positioned, it is walking distance to either Warwick Farm/Liverpool train stations and Westfield.

- Spacious open living and dining zone with ideal outdoor flow
- Wide balcony with district views, perfect for hosting friends
- Stone finished kitchen complete with quality gas appliances
- Master bedroom includes ensuite, built-in and private balcony
- Bathroom has shower and bathtub, separate internal laundry
- Air conditioning, intercom, two secure basement car spaces
- Complex boasts child-friendly courtyard with play equipment
- Sensational opportunity for first homebuyers or investors

**Price:** \$460,000 - \$490,000



**Glen Craigie**

0401 529 930



**Glen Craigie**

0401 529 930

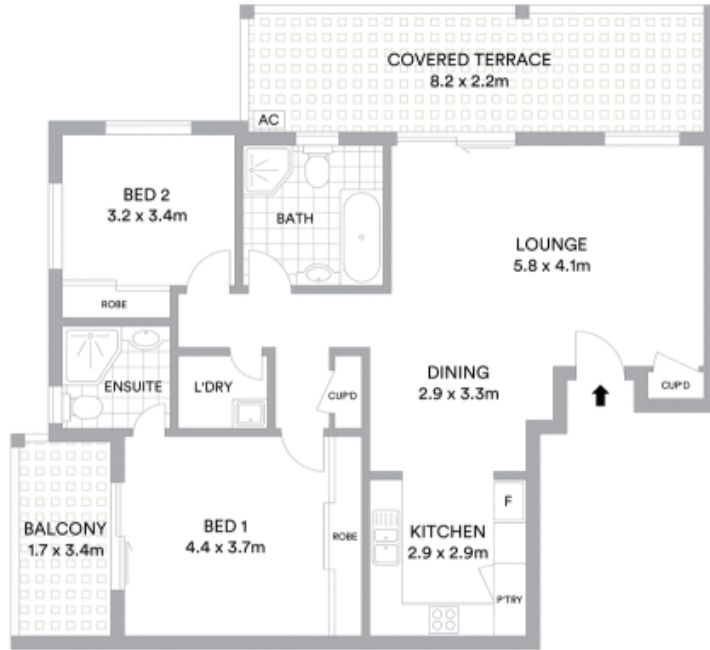

LEVEL SIX

Total area 114sqm

**McGrath**

Scale in metres. Indicative only. All information contained herein is obtained from sources we believe to be accurate. We cannot guarantee its accuracy. Interested persons should make and rely on their own enquiries