



21 Figtree Crescent Glen Alpine, NSW



### Sold By McGrath Estate Agents Liverpool

Price: \$1,049,000

Backing onto the peaceful green fairways of Campbelltown Golf Course, this well maintained family home is being offered for the first time. Set over a substantial 1,551sqm, it's steps from buses to rail, while near schools and vibrant Macarthur Square.

- Sprawling interiors offer an enviable choice of living zones
- Versatile rumpus flows to a superb covered entertaining area
- Salt water pool and spa, landscaped gardens, ample lawn space
- Ideal for active children, shed plus gate entry to golf course
- Tidy kitchen with abundant cabinetry and electric appliances
- Generous bedrooms, master features walk-in robe and ensuite
- Main bathroom has corner bath, downstairs guest w/c and shower
- Rarely offered four car garage, convenient internal access

Stone Real Estate

02 9824 1100  
Liverpool

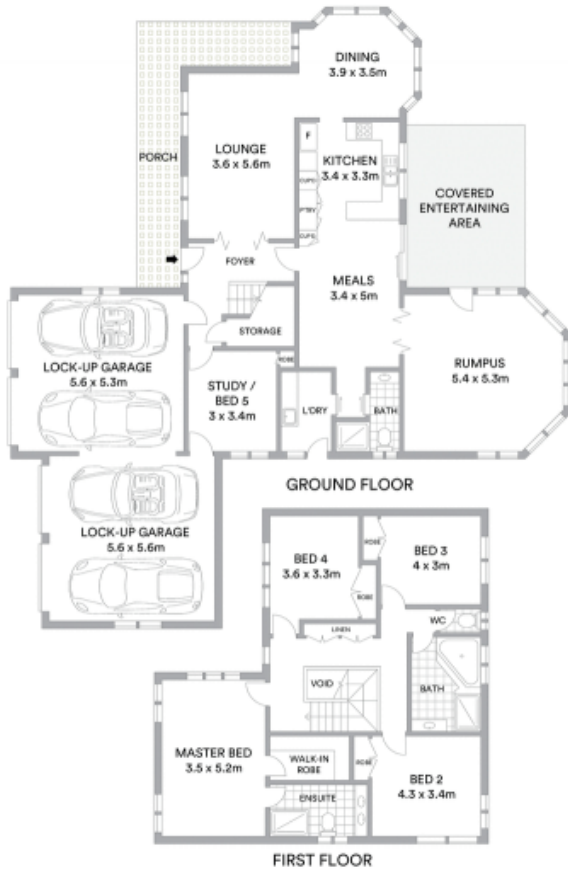

Internal 286sqm  
Land area 1,551sqm

**McGrath**

Scale in metres. Indicative only. All information contained herein is obtained from sources we believe to be accurate. We cannot guarantee its accuracy. Interested persons should make and rely on their own enquiries