



143 Canberra Street St Marys, NSW 5 [bed icon] 3 [bath icon] 2 [car icon]

Sold by Glen Craigie, McGrath Estate Agents

Price: \$775,000 - \$825,000

Embracing a north to rear aspect, this double brick home plus granny flat accommodates versatile extended family living. It's set within a few minutes' drive of St. Mary's Village and station, an easy stroll to Oxley Park Public School and buses.

- Generous layout provides at least five distinct living zones
- Alfresco entertaining and level lawn with northern sunshine
- Classic kitchen features an electric cooktop and servery
- Generously sized bedrooms, master with ensuite
- Quality built residence ready to enjoy, full brick on ground floor
- Four bathrooms, spacious laundry, additional home office
- Detached granny flat presents scope to personalise and modernise
- Additional separate workshop and storage shed at the rear



Glen Craigie
0401 529 930



Glen Craigie
0401 529 930



GROUND FLOOR

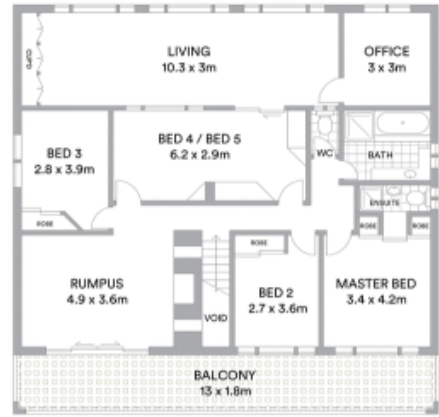

FIRST FLOOR



Internal 344sqm
Land area 1,088sqm

McGrath

Scale in metres. Indicative only. All information contained herein is obtained from sources we believe to be accurate. We cannot guarantee its accuracy. Interested persons should make and rely on their own enquiries