



66 Begovich Crescent Abbotsbury, NSW

4 3 2

Solid and spacious family lifestyle

Surrounded by attractive homes on one of Abbotsbury's premier streets, this versatile residence presents a great investment opportunity with scope for enhancement. The estate offers an abundance of living space close to schools, shops and buses.

- A choice of formal and casual lounge, dining and family areas
- Flowing living areas framed by high ceilings and a fireplace
- Functional eat-in gas kitchen, stainless steel appliances
- Generous bedrooms most with mirrored built-in wardrobes
- Deluxe master suite with a parents' retreat and walk-in robe
- Several functional bathrooms with tubs and modern hues
- Other features includes ducted air conditioning and alarm
- Separate studio accommodation to the rear of the home

Price: Price guide over \$450,000



Frank Bartolone

0411 477 758

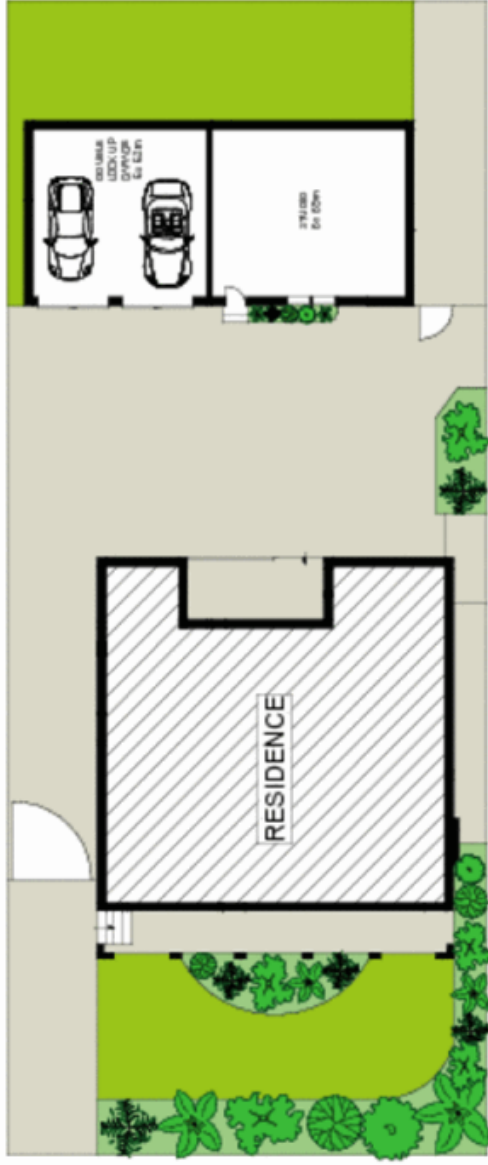

SITE PLAN (NOT TO SCALE)



GROUND LEVEL



LEVEL ONE

0 1 2 3 4 5

Scale in metres. Indicative only. Dimensions are approximate. All information contained herein is gathered from sources we believe to be reliable. However, we cannot guarantee its accuracy and interested persons should rely on their own enquiries.



66 Begovich Crescent, Abbotsbury

McGrath