



8 Fairlawn Close LANSVALE, NSW



Spacious entertainer near Chipping Norton Lake

Enjoying a premier position close to Chipping Norton Lake, this single level home offers a spacious family haven with excellent outdoor entertaining facilities. It's centrally located in a friendly cul-de-sac, a walk from Cherrybrook park and nearby buses.

- Generous carpeted formal dining and separate formal lounge
- Spacious and light family room features easycare tiled floors
- Inviting in-ground swimming pool, pergola for alfresco meals
- Large gas equipped kitchen with storage and a breakfast bar
- Well scaled bedrooms fitted with built-ins and neutral carpet
- Master bedroom features a walk-in wardrobe and an ensuite
- Family sized main bathroom with a bath tub and separate w/c
- Internal laundry with access to yard, garden shed, side access

Price:

Price guide \$700,000 - \$770,000

Stone Real Estate

02 9824 1100
Liverpool

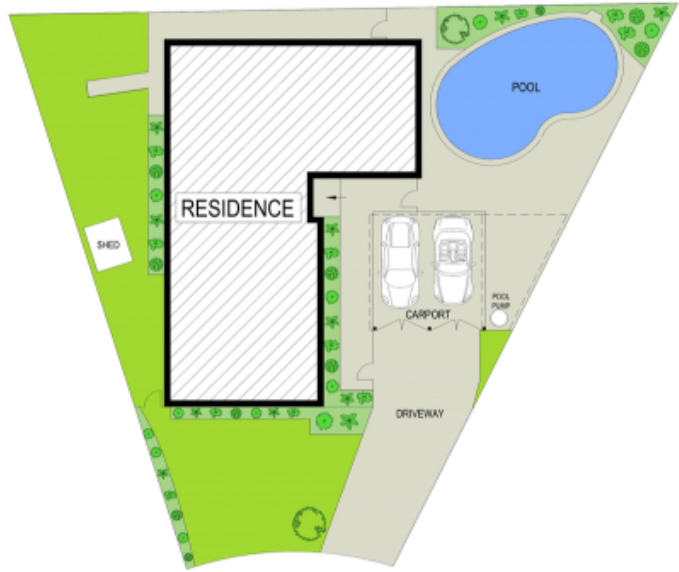
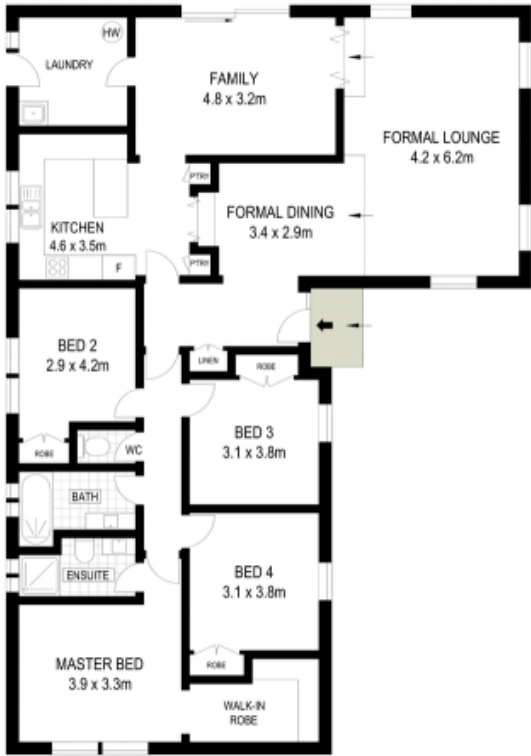

McGrath

Scale in metres. Indicative only. Dimensions are approximate. All information contained herein is gathered from sources we believe to be reliable. However we cannot guarantee its accuracy and interested persons should rely on their own enquiries