



67 Restwell Road BOSSLEY PARK, NSW

5

2

2

Dual level residence offering immense potential

Occupying an elevated position set back from the street, this dual level residence offers immense potential to build a separate dwelling or create a home business (STCA). It is placed in a convenient locale close to Marconi and Stockland Shopping Mall.

- Breezy floorplan offers a choice of living and dining areas
- Child-friendly level backyard bordered with easycare gardens
- Sleek kitchen is equipped with stainless steel gas appliances
- Five good sized bedrooms each fitted with built-in wardrobes
- Main bathroom features a separate bath and shower plus a w/c
- Ducted air conditioning, alarm system, storage, combustion heater
- Polished timber floors, neutral decor and quality finishes
- Airy sunroom, home study and an additional rumpus upstairs

Price:

Price guide over \$600,000

Stone Real Estate

02 9824 1100
Liverpool

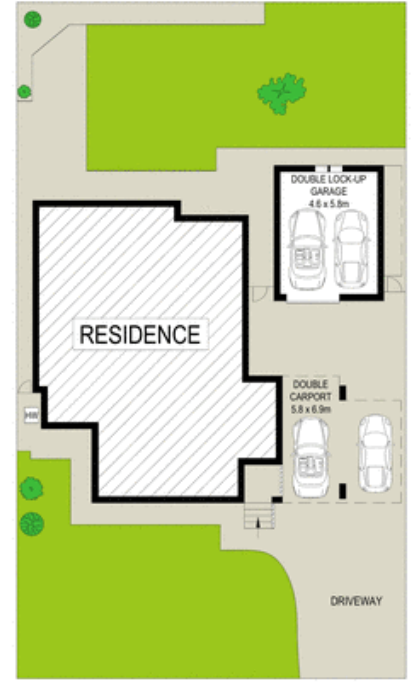
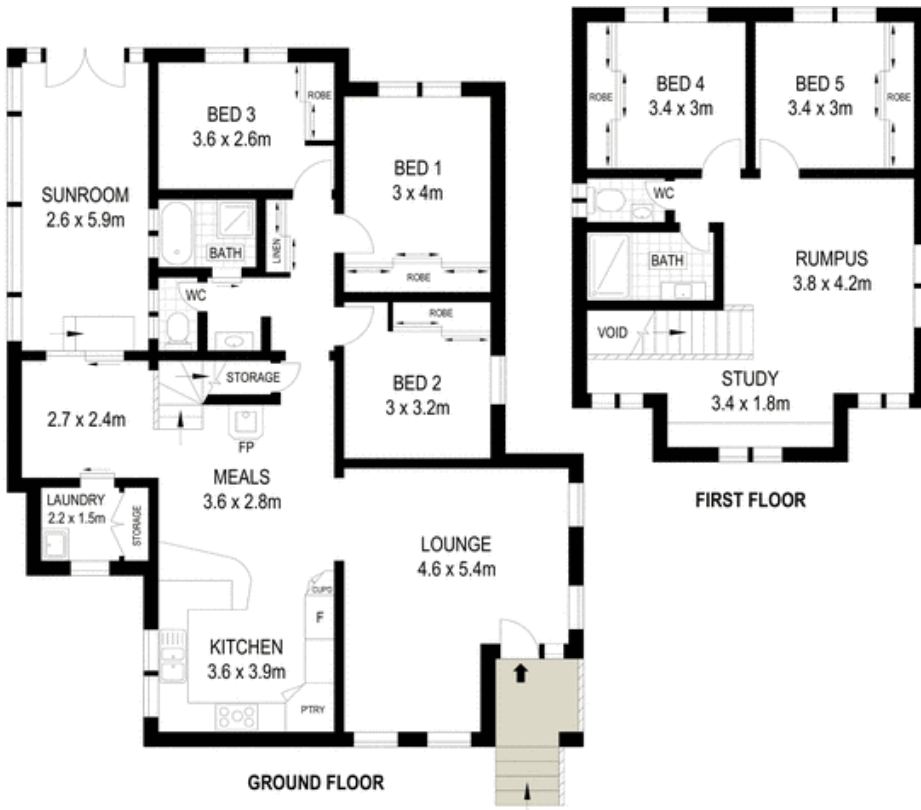

Scale in metres. Indicative only. Dimensions are approximate. All information contained herein is gathered from sources we believe to be reliable. However we cannot guarantee its accuracy and interested persons should rely on their own enquiries



67 Restwell Road, Bossley Park

McGrath