

10 Kingston Place ABBOTSBURY, NSW



Resort style living amid award winning garden

Heralding resort style living over 1,431sqm, this single level full brick home is set amid award winning gardens within walking distance to Western Sydney Parklands from rear access. It boasts classic street presence and embraces city views to ensure undeniable appeal.

- Formal lounge and dining with high ceilings, gas fireplace
- Vast family living and casual dining with brushbox timber floors
- Timber kitchen with gas cooktop, capacious walk-in pantry
- Large bedrooms, two with built-ins, master has ensuite, walk in robe
- Three bathrooms, skylight in main, separate spa in garage
- Alarm, terracotta roof, separate double garage with attic storage
- Workshop and shed with three phase power
- Alfresco entertaining areas, built in BBQ and surround in-ground pool

Stone Real Estate

02 9824 1100
Liverpool



SITE PLAN (NOT TO SCALE)



Scale in metres. Indicative only. Dimensions are approximate. All information contained herein is gathered from sources we believe to be reliable. However we cannot guarantee its accuracy and interested persons should rely on their own enquiries



GROUND FLOOR

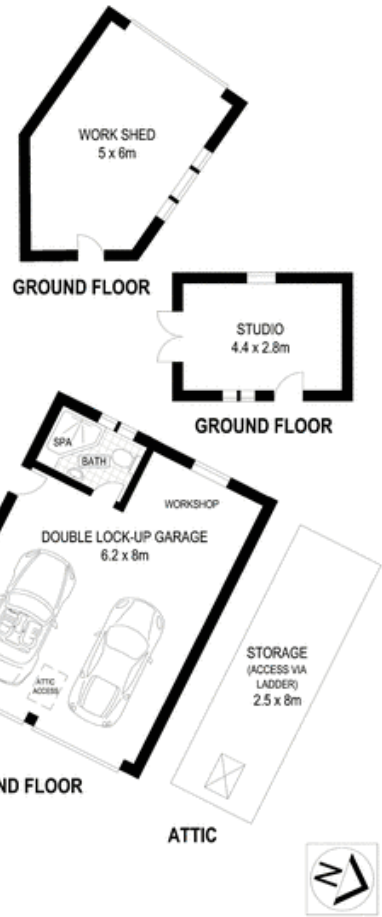

GROUND FLOOR

ATTIC

10 Kingston Place, Abbotsbury

McGrath