



83 Rossini Drive HINCHINBROOK, NSW



Contemporary family living in exclusive enclave

Flowing over two spacious light filled levels and boasting three separate living/entertaining spaces, this home is a haven of stylish contemporary family living. It's positioned in an exclusive enclave central to schools, parks, bus transport and shops.

- Vast open plan indoor/outdoor entertaining with garden view
- Formal lounge and separate dining rooms plus rumpus retreat
- Covered terrace with cooking/cleaning facilities, level rear garden
- Gas kitchen, granite benchtops, stainless steel appliances
- Bedrooms with built-ins, bathrooms with bathtubs, third w/c
- Enormous master bedroom suite with walk-in robe and ensuite
- Ducted air conditioning, ducted vacuum, storage under stairs
- Large drive through double garage with internal access

Stone Real Estate

02 9824 1100
Liverpool

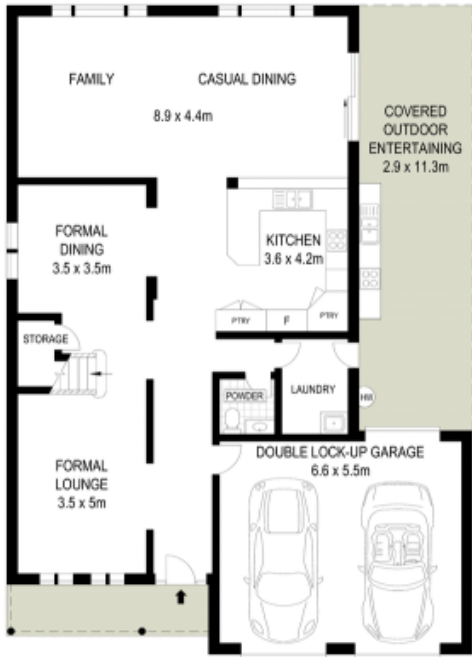

GROUND FLOOR



FIRST FLOOR



McGrath

Scale in metres. Indicative only. Dimensions are approximate. All information contained herein is gathered from sources we believe to be reliable. However we cannot guarantee its accuracy and interested persons should rely on their own enquiries