

STONE



16/35-43 Penelope Lucas Lane Rosehill, NSW



Recently Refreshed 2 Storey Apartment in Prime Rosehill Location

Creatively designed two-level apartment located in the heart of Rosehill. With a unique layout and modern finishes, this spacious 2 bedroom + oversized study, 3 bathroom residence boasts a high cathedral ceiling & skylights - offering a sense of space, bright interiors and comfortable apartment living.

Price: \$700.00 pw

Available Date: 21/07/2025



Bella Losurdo

02 9630 8899

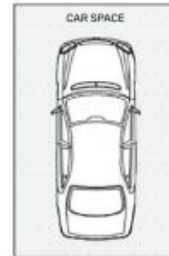
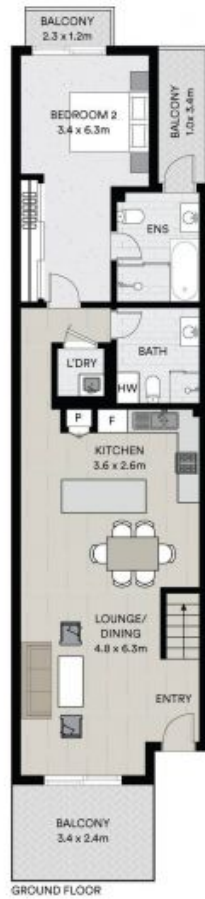

*Floorplan of unit 15, identical dimensions although floorplan is inverted.



All information contained in this document is from sources we believe to be accurate, however we cannot guarantee its accuracy. Interested persons should make and rely on their own enquiries in relation to measurements, dimensions, layout, furniture and description.