

22 Mills Avenue Asquith, NSW 3 1 1

Three-bedroom home in family-friendly pocket of Asquith

Featuring living and dining rooms with wonderful outlooks, electric kitchen, three spacious bedrooms with wardrobes, fresh paint and carpet throughout, covered outdoor patio, manicured backyard and under house workshop and storage. In close proximity to Asquith Train Station, locals schools, parks and cafes, this home offers a prime location for families.

Price: \$820 Per week
Bond: \$3,280
Available Date: 09/08/2025



Matthew Mey
0456 712 478



Ground Floor

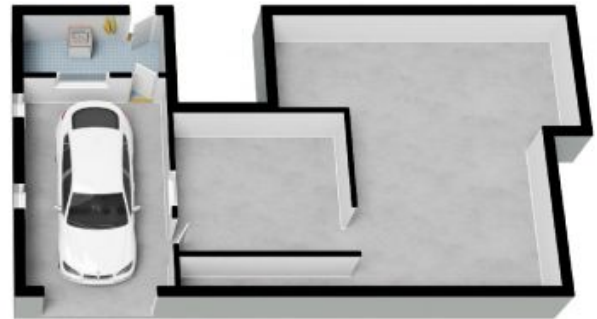

1st Floor

Internal Living: 190 sqm
External Living: 20 sqm
Total Living Area: 210 sqm



The floor plan is not to scale; measurements are indicative and in metres. All features included in this 3D plan are for inspiration purposes only. This is not an exact replica of the property or the position of exterior elements. Plans should not be relied on. Interested parties should make and rely on their own enquiries.