



23/1 Addison Road Manly, NSW

3

2

1

### Iconic waterfront building, sublime harbour panoramas

Poised on the tip of Smedley's Point, this newly renovated apartment seems to float above the water. Part of the iconic 'Kilburn Tower', it radiates with natural light, showcasing an inspired design wrapped in glass with 180° panoramas including to the N/E that sweep across Middle Harbour to the city and beyond. Move in and wake up to beauty everyday steps to the best of Manly.

**Price:** \$2,990,000



**Candice Cattell**

0417 311 777



**Sam Bursill**

0449 969 452

23/1 Addison Road  
Manly

STONE

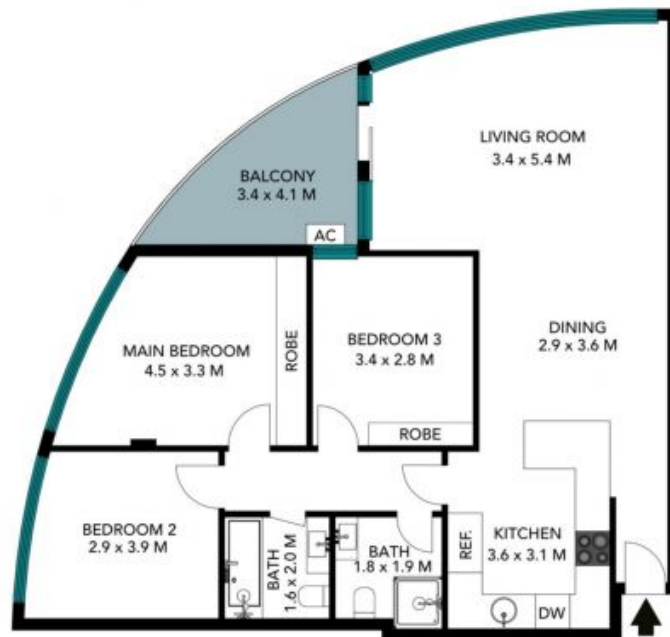

(NOT IN POSITION)



The floor plan is not to scale, measurements are indicative and in metres. Exterior elements are not in position. Plans should not be relied on. Interested parties should make and rely on their own enquiries. All other information provided has been collected from reliable sources but cannot be guaranteed for accuracy.

23/1 Addison Road  
Manly

STONE

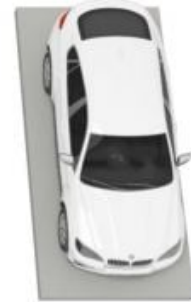

The floor plan is not to scale; measurements are indicative and in metres. All features included in this 3D plan are for inspiration purposes only. This is not an exact replica of the property or the position of exterior elements. Plans should not be relied on. Interested parties should make and rely on their own enquiries.