

30 Stevens Street Southport, QLD

2 1 1

Act Fast - Outstanding Location - Walk to the Broadwater & Chirn Park

This charming two-bedroom cottage is perfectly positioned within walking distance to the Broadwater, Chirn Park shops, cafes, and restaurants. Featuring a classic cottage-style layout, it offers a separate lounge, sunroom, and kitchen that opens out to a spacious backyard. Tucked just off the main road, the home provides easy access to everything the Gold Coast has to offer, with Australia Fair Shopping Centre, Griffith University, and the Gold Coast University Hospital all just a short drive away.

Price: \$700 pw
Available Date: 15/09/2025



Stefanie Mullin

0413 707 396

30 Stevens Street
SOUTHPORT QLD 4215

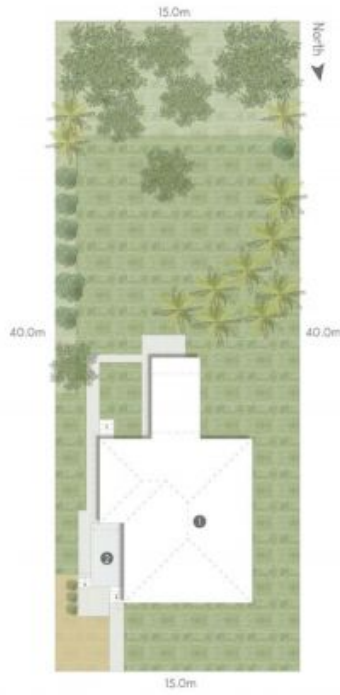

30 Stevens Street, Southport
 2 bed | 1 bath | 1 car

Property Size

Internal	82m ²
Screened Porch	8m ²
Total	90m²

Lot Size 607m²

Legend

1. Residence
2. Screened Porch



© Coastal Pty Limited ABN 30 101 817 798. Content of this publication is subject to copyright. The views expressed are not necessarily those of Coastal or its agents. The information is correct and reliable as at the date of printing and may be subject to change without notice. Reproduction in whole or part of this publication is not permitted without written consent of Coastal.