

Actual view



Actual view

3/1 Addison Road Manly, NSW



Prestigious waterfront residence with iconic outlooks

Perched on the tip of Smedley's Point, this newly renovated apartment in the renowned Kilburn Tower feels as though it floats above the harbour. Wrapped in glass and bathed in natural light, it captures breathtaking 180° views stretching from Middle Harbour to the city skyline. Offering a seamless blend of style, comfort and convenience, it's a rare opportunity to secure a front-row seat to Manly's best.

Price: \$3,300,000



Candice Cattell

0417 311 777



Sam Bursill

0449 969 452

3/1 Addison Road
Manly

STONE

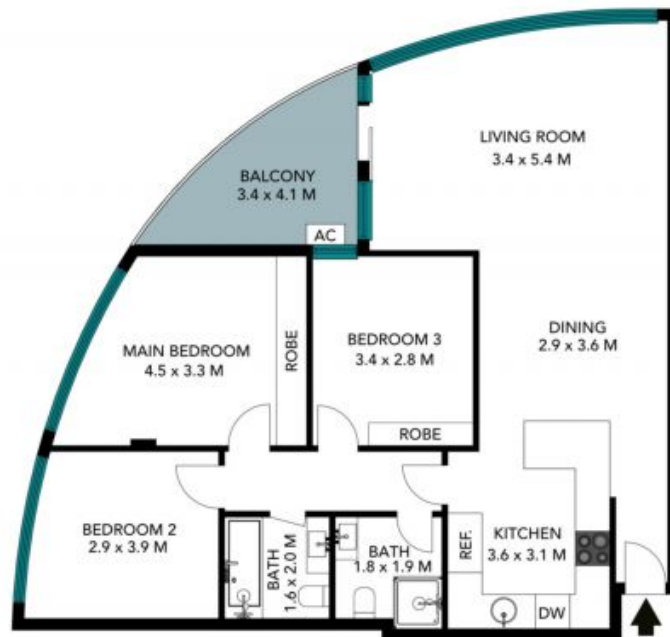

(NOT IN POSITION)



The floor plan is not to scale, measurements are indicative and in metres. Exterior elements are not in position. Plans should not be relied on, interested parties should make and rely on their own enquiries. All other information provided has been collected from reliable sources but cannot be guaranteed for accuracy.

3/1 Addison Road
Manly



The floor plan is not to scale; measurements are indicative and in metres. All features included in this 3D plan are for inspiration purposes only. This is not an exact replica of the property or the position of exterior elements. Plans should not be relied on. Interested parties should make and rely on their own enquiries.