



96 Shirley Road Roseville, NSW

4

2

2

**First time offered in 48 years!**  
**Move in now, redesign later: No conservation and no heritage**

Much loved family home, offered for the first time in 48 years. This impeccably presented, full brick family home offers the option of move straight in or build free from any worries of heritage or conservation restrictions. Refreshingly updated, this inviting home blends single level modern living with original charm and stunning established gardens. With 904sqm of level, private land, the options for improvement are endless (STCA).

**Price:**

Sold prior to auction



**Jill Henry**

0416 493 555



**Sahil Kotian**

0434 172 588

96 Shirley Road  
Roseville

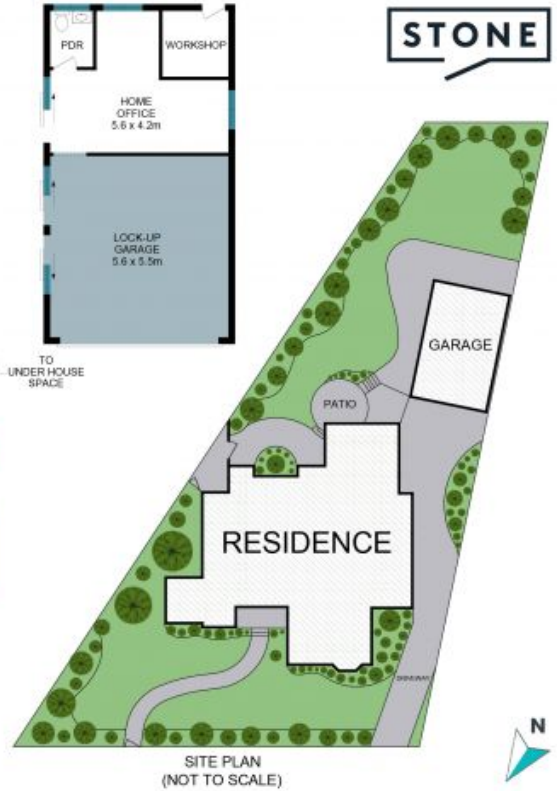

The site plan and floor plan are not to scale; measurements are indicative and in metres. Bushes and trees are placed for illustration purposes. Plans should not be relied on. Interested parties should make and rely on their own enquiries. All other information provided has been collected from reliable sources but cannot be guaranteed for accuracy.