



20 Spearman Street Roseville, NSW



Entertainer boasts next-level tech on Chatswood's tranquil edge

Wrapped in picket-fence charm and framed by wisteria, this fully renovated home is as pretty as it is innovative. A wide verandah leads to interiors of superb quality, where light, space, and outdoor flow create an open expression of modern family living.

Price:

Contact Agent



Jill Henry

0416 493 555



Bridget Sutherland

0413 741 496

20 Spearman Street
Roseville

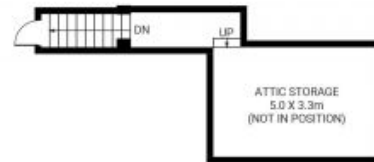

The site plan and floor plan are not to scale; measurements are indicative and in metres. Bushes and trees are placed for illustration purposes. Plans should not be relied on. Interested parties should make and rely on their own enquiries. All other information provided has been collected from reliable sources but cannot be guaranteed for accuracy.