



6 The Greenway Duffys Forest, NSW

5 

1 

3 

4 

Sprawling classic luxury estate offering unrivalled lifestyle

Price: Deposit Taken
Bond: \$12,000
Available Date: 20/10/2025



Anthony Zakos

0419 503 000



Ruby Gibson

0420 466 538

6 The Greenway
Duffys Forest



Ground Floor

Internal Living: 413 sqm
External Living: 135 sqm
Total Living Area: 548 sqm



1st Floor

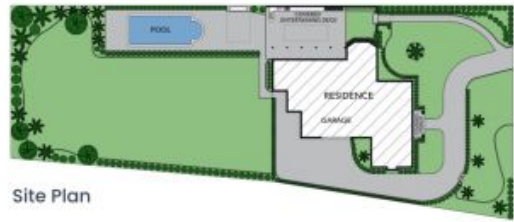

Site Plan



The site plan and floor plan are not to scale; measurements are indicative and in metres. Bushes and trees are placed for illustration purposes. Plans should not be relied on. Interested parties should make and rely on their own enquiries. All other information provided has been collected from reliable sources but cannot be guaranteed for accuracy.

6 The Greenway
Duffys Forest

STONE



Ground Floor

Internal Living: 413 sqm
External Living: 135 sqm
Total Living Area: 548 sqm



The floor plan is not to scale; measurements are indicative and in metres. All features included in this 3D plan are for inspiration purposes only. This is not an exact replica of the property or the position of exterior elements. Plans should not be relied on. Interested parties should make and rely on their own enquiries.