



9 Buyuma Street Carlingford, NSW

6

4

2

Grand Family Home with Dual Living

Positioned in a quiet street, this modern spacious family home offers an amazing dual living plus external separate guest accommodation. This unique property perfectly suits an extended family or savvy investors. It enjoys a leafy views back onto a reserve.

Price: \$2,000,000



Juliet (Jiangmin) Chen

0408 997 997

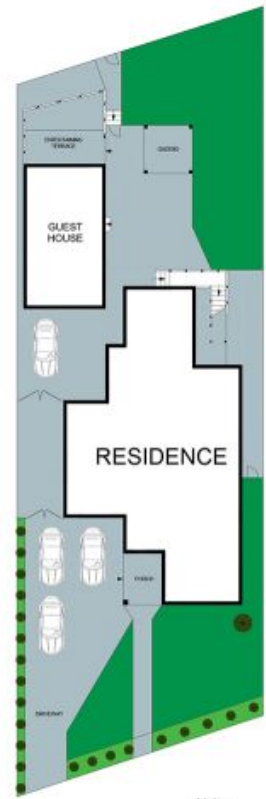

The floor plan is not to scale; measurements are indicative and in metres. Exterior elements are not in position. Plans should not be relied on. Interested parties should make and rely on their own enquiries.

9 Buyuma Street, Carlingford

Internal Area Approx. - 346 sqm
 External Area Approx. - 42 sqm
 Land Area Approx. - 715 sqm

