



16 Harrow Road Bexley, NSW

4 

2 

4 

Charming Federation-Style Home in Prime Location

Set on a 518.5 sqm block, this four-bedroom Federation-style home offers timeless elegance with room to move. Ideal for families or buyers seeking a blend of classic charm and modern comfort, this residence is a rare find in a sought-after location.

Price: SOLD | \$1,750,000



Sam Abbas

0406 750 075



EJ Joseph

0432 969 029

16 Harrow Road
Bexley

STONE

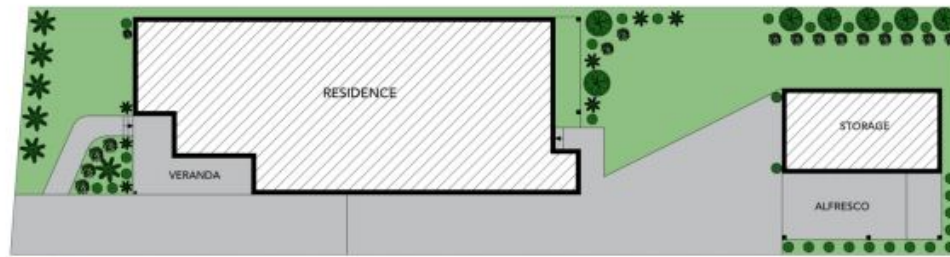

Site Plan



(NOT IN POSITION)



The site plan and floor plan are not to scale; measurements are indicative and in metres. Bushes and trees are placed for illustration purposes. Plans should not be relied on. Interested parties should make and rely on their own enquiries. All other information provided has been collected from reliable sources but cannot be guaranteed for accuracy.

16 Harrow Road
Bexley



The floor plan is not to scale; measurements are indicative and in metres. All features included in this 3D plan are for inspiration purposes only. This is not an exact replica of the property or the position of exterior elements. Plans should not be relied on. Interested parties should make and rely on their own enquiries.